



STAINLESS STEEL

# CHEMICAL STORAGE CABINET



WCH-15-24 Left Hinged Shown (Standard)\*



**FEATURES:**

- Overall Size: 15" x 24" x 32 1/2"
- Left-Hinged Door\*
- Vented Side Panels
- One Fixed Mid-Shelf
- Wall Mounting Hardware Not Included

**CONSTRUCTION:**

- All TIG welded using the TIG process.
- Welded seams finished to match adjacent surfaces.
- Unit polished to a satin finish.

Item #: \_\_\_\_\_ Qty #: \_\_\_\_\_

Model #: \_\_\_\_\_

Project #: \_\_\_\_\_

**MATERIAL:**

- WCH-15-24:**  
18 gauge type 430 series stainless steel
- WCH-15-24-300:**  
18 gauge type 300 series stainless steel
- Stainless steel hinge
- Plastic Handle
- Mounting hardware is not supplied



Vented Side Panels

Model #	Material	Approx. Wt.	Approx. Cu.
WCH-15-24	18 Ga., 430 S/S	90	12
WCH-15-24-300	18 Ga., 300 S/S	90	12

\*Optional Right-Hand Door Swing Available - Add CAB-R  
 Additional Fixed Mid-Shelf - Add WC-SHELF  
 Repair Kit For Door Hinge (Per Hinge) - TA-36D

## DIMENSIONS and SPECIFICATIONS

TOL ± .500"

ALL DIMENSIONS ARE TYPICAL

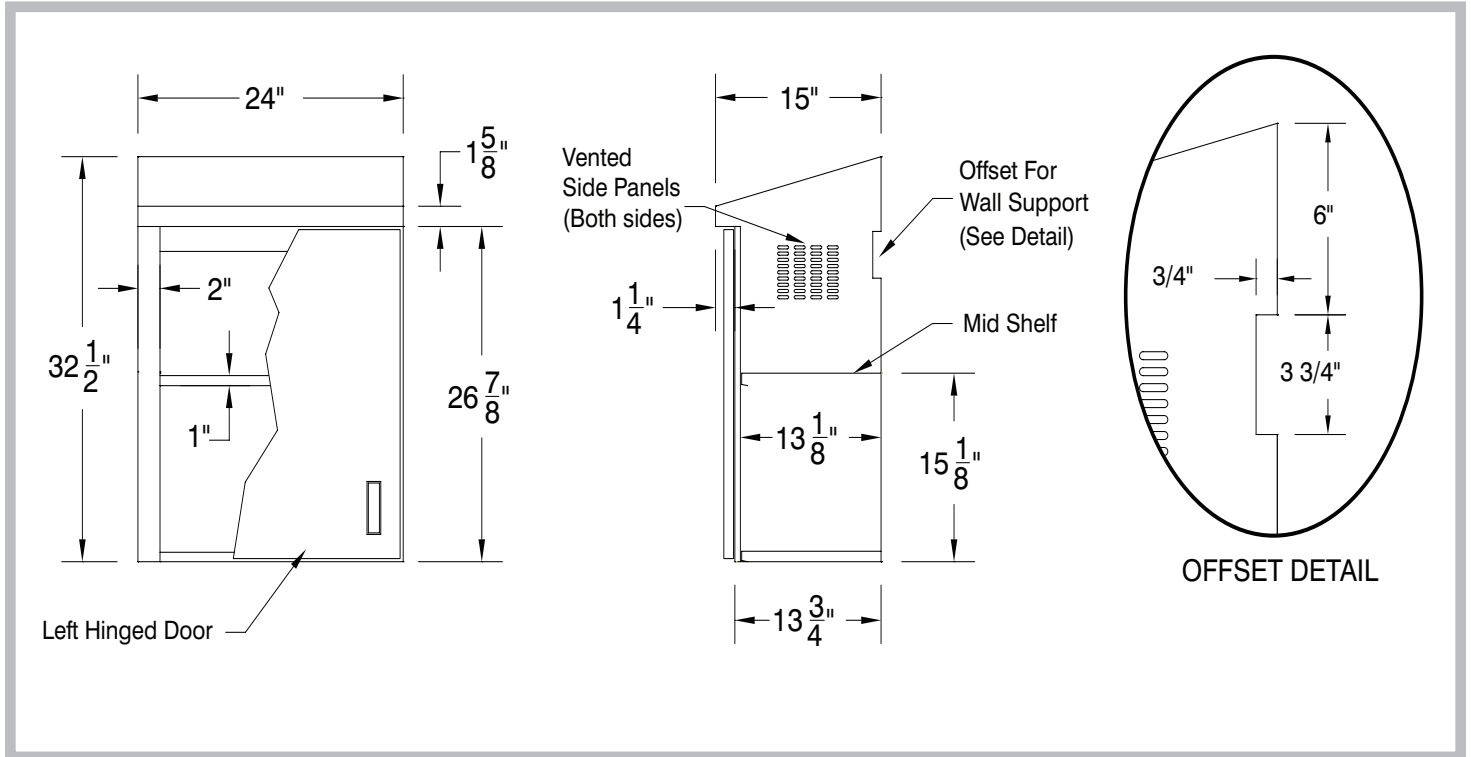

Customer Service Available To Assist You **1-800-645-3166** 8:30 am - 7:00 pm E.S.T.

For Orders & Customer Service:

Email: [customer@advancetabco.com](mailto:customer@advancetabco.com) or Fax: 631-242-6900

For Smart Fabrication™ Quotes:

Email: [smartfab@advancetabco.com](mailto:smartfab@advancetabco.com) or Fax: 631-586-2933